



Linear Unit SLG

Art. Nr.: 904.xxxxx

The housing of the linear unit **SLG** is made out of a colorless anodized aluminium profile with dimension 45x45 mm. The steel piston pipe is guided in a plastic bushing and is moved by an inline spindle drive.

Up to 4 linear units can be connected to one control box and are operated synchronous with a hand switch.

Application

Work stations, machine and furniture industry

The system **SLG** is used in applications which need ergonomic height adjustable work surfaces.

Especially existing work stations can be retrofitted with linear units. The dimension **45x45 mm** fits perfectly in steel profiles 50x50mm, which are often used as carriers and legs for work stations.

The linear unit **SLG** can withstand higher bending moments and is more stable than the linear unit SLA with dimension 35x35mm.

Technical Data Linear Unit SLG

High loads with small dimension

| | |
|---------------------------|----------------------------|
| Max. lifting load per SLG | 1500 N |
| Max. pulling load per SLG | 1500 N |
| Max. static bendingmoment | $M_b = 250 \text{ Nm}$ |
| Max. dyn. bendingmoment | $M_{bdyn} = 80 \text{ Nm}$ |
| Stroke length | 300 or 400mm |
| Fitting length A | 600 or 700mm |

Technical Data System SLG

Plug & Play

| | |
|---|--------|
| 1-4 SLG per control box plus 1x hand switch | |
| Max. lifting load 4-leg-system | 6000 N |
| Lifting speed | 9 mm/s |

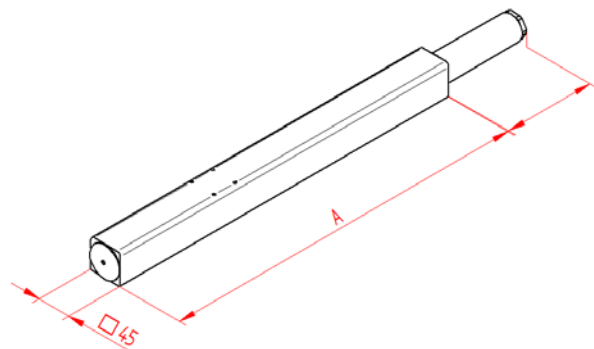

Download CAD data at www.ergoswiss.com

The linear unit SLG offers, compared to the hydraulic linear unit LG, an improved stability for your mobile or stationary workstation and does not need a retracting force or a retracting spring. The SLG can be used for both pressure and tensile loads, which enables a broad range of application. In addition, the linear unit SLG offers more freedom in designing your workstation, since no hydraulic pump is required. The spindle lifting system can be assembled in a short time.

We recommend the SLG linear unit for industry, furniture and catering.

